

# Quick Start Manual

## Mini Mite™ RABIS-M 3.0



[www.beveltools.com](http://www.beveltools.com)



# Quick Start Manual Mini Mite™ RABIS-M 3.0



## 1 • Preparing the machine

1 ON OFF

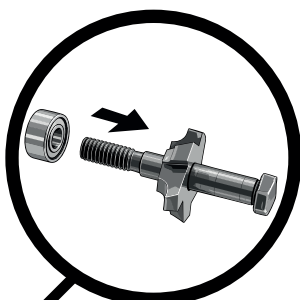
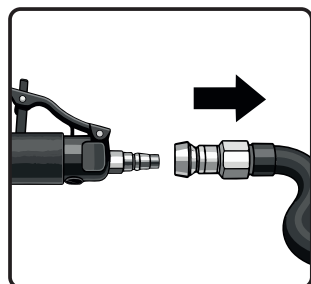

2

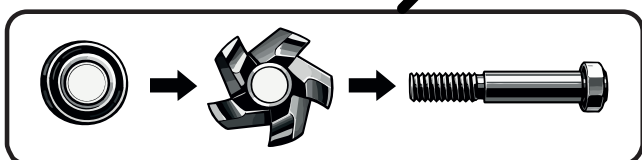

3

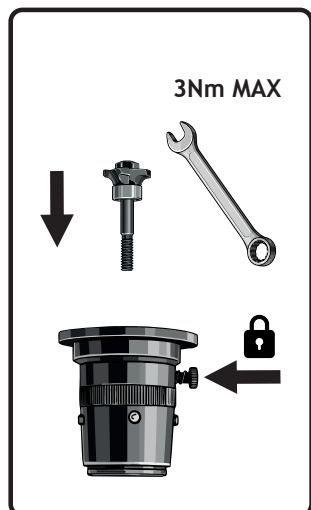

4

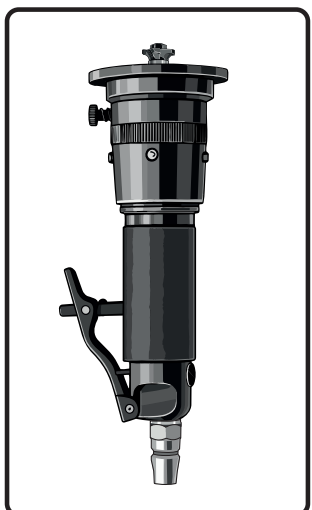

## 2A • Adjusting the depth (beveling)

1 ON OFF

2

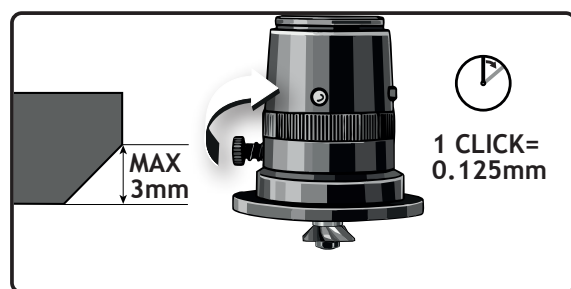

## 2B • Adjusting the depth (rounding)

1 ON OFF

2

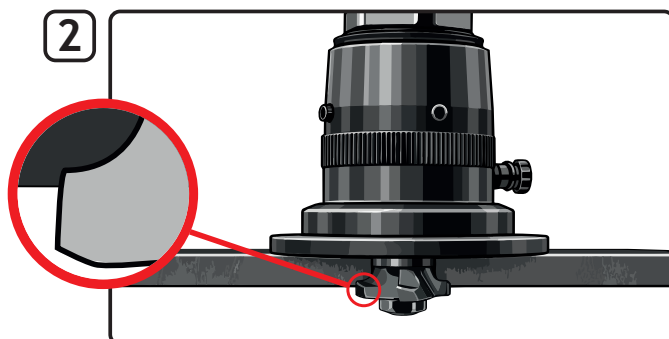

3

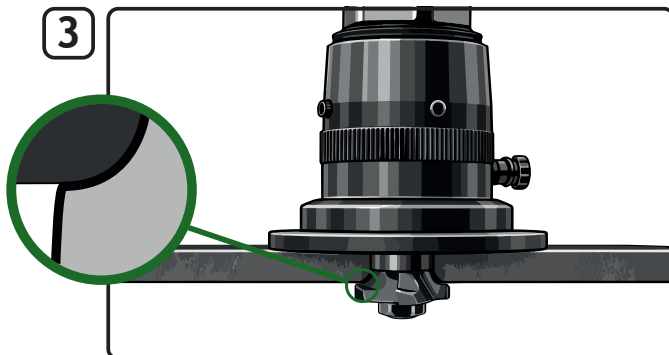

## Maintenance

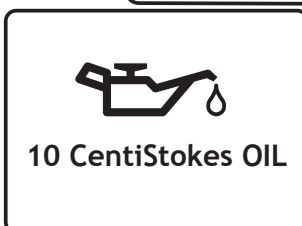
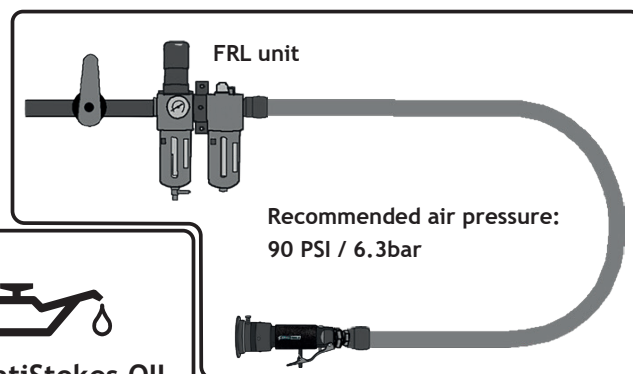

### 3 • Usage

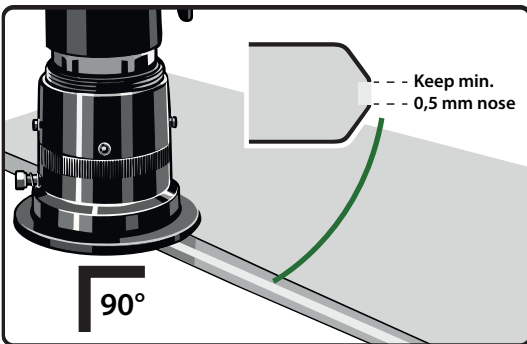
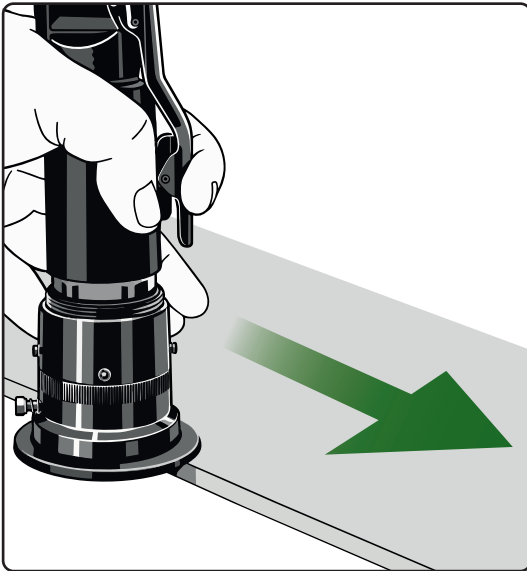

### 4A • Bevel direction

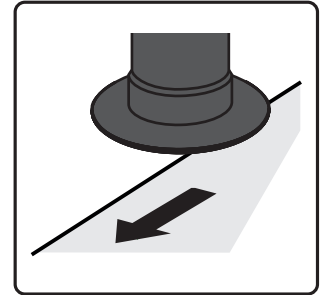
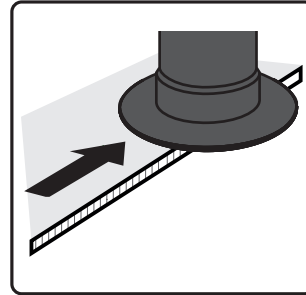

### 4B • Contour beveling steps

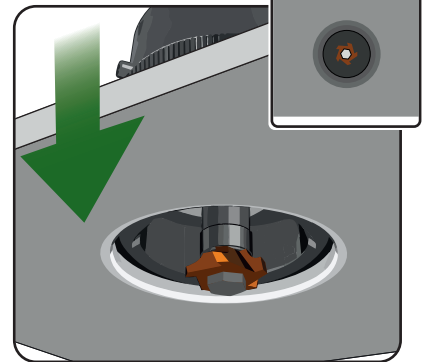
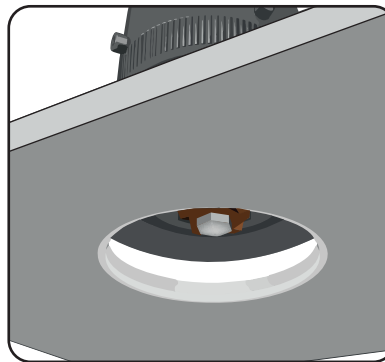

3

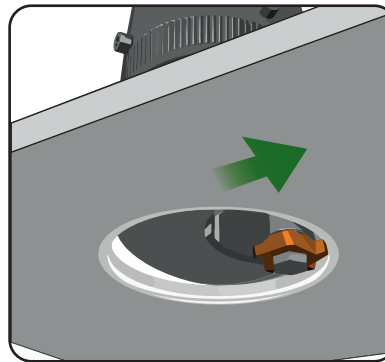

4

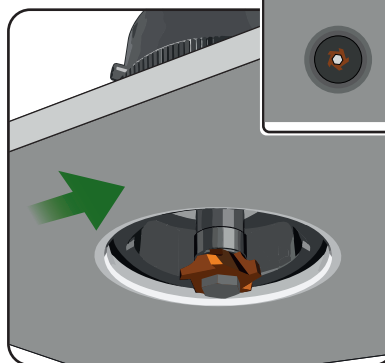
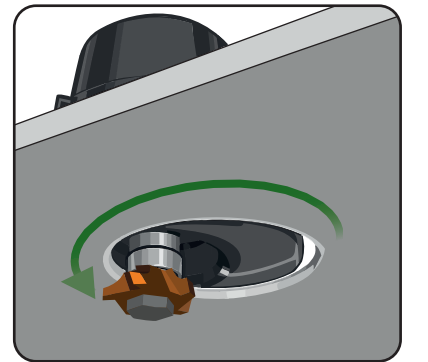

6

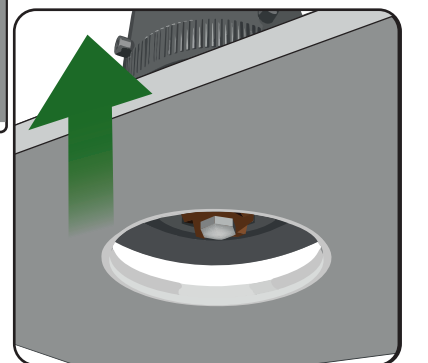

# Mini Mite™ RABIS-M

Bevel heads / Freeskoppen / Fräsköpfen / Cabezales de corte



## Radius



## Angle

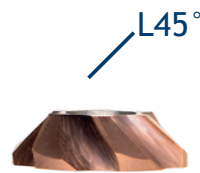

Available in / Verkrijgbaar in / Erhältlich in / Disponible en

VERSION  
**3.0**



YouTube

[www.youtube.com/beveltools](http://www.youtube.com/beveltools)

Beveltools B.V.  
Florijnweg 33  
6883 JN  
Velp (Gld)  
The Netherlands

T +31 (0)26 369 92 22  
E [info@beveltools.com](mailto:info@beveltools.com)

Beveltools Inc.  
PO Box 1573  
Sikeston  
MO 63801  
United States

T +1 636 579 9421  
E [sales@beveltools.com](mailto:sales@beveltools.com)

